

WEST MIDLAND FAMILY CENTER'S

Family

F



OCUS

ENHANCING THE QUALITY OF LIFE FOR AREA RESIDENTS OF ALL AGES

VOLUME 10, NUMBER 2 • 4011 W. Isabella Road • Shepherd, MI 48883 • (517) 832-3256 • SUMMER 1999



Expansion Project Promises Continuing Growth for WMFC

Dow Foundation Renews Matching Grant at 3-1 Ratio

The Herbert H. and Grace A. Dow Foundation has "done it again"! The Foundation has renewed its matching grant for another five years, increasing the ratio to three-for-one. For every dollar West Midland Family Center raises in the next five years, the Foundation has pledged a contribution of \$3.00. This gives the Center the opportunity to earn \$1,000,000.00 while raising \$333,000.00.

This new pledge follows closely the completion of the original five-year pledge, during which the Foundation contributed \$1,214,930, matching on a 1-1/2 to 1 basis the \$485,972 the Center raised.

The money raised, as was the case with the original grant, will become part of the Center's Program Endowment Fund, and support the broad spectrum of programs which are made available to the West Midland community. It will also become an important factor in supporting additional programs and services which will

See MATCHING GRANT, Page 3

West Midland Family Center (WMFC) is embarking on a major expansion project which will enable the Center to expand its programs and services in every area. The project will include four major elements, with some functional overlap. These elements include additional facilities for educational programs and services, a second gymnasium, an outdoor swimming pool, and modifications for additional conference rooms and office space.

Ginger Yarch Wins Strosacker Award

The Charles J. Strosacker Award recognizes outstanding efforts by a staff person of a Midland County United Way agency. The award has been awarded annually since 1990. At the United Way's annual meeting in January, the award for 1998 was presented to West Midland Family Center's own Ginger Yarch.



Ginger Yarch

Ginger has been the Child Care Director at the Center since 1996 and prior to that she had worked as an Aide in the Preschool Classroom for an additional six years. Ginger has overseen the introduction of the Child Care Program at WMFC and has been instrumental in setting the high standard of excellence that every parent has come to count on.

See GINGER YARCH, Page 4

According to Bob Dostal, WMFC President, "completion of the project will markedly improve the efficiency of the present facility and will enable the Center to enhance the services to the community. We will be able to expand adult recreational services by 125%, youth and teen activities by 100%, family support services by 50%, day care by 50% and preschool services by 25%. The relative needs in these specific areas largely governed our expansion planning."

West Midland Family Center is celebrating two significant milestones this year. This is the 25th anniversary (see related stories) of the founding of the Center in the former Greendale School, and also marks the 10th anniversary of the dedication of the current facility.

According to Greg Dorrien, Executive Director, "the tremendous growth we have experienced over the past 10 years is now placing a severe burden on our physical plant. We have reconfigured our space to use every inch, but

See EXPANSION PROJECT, Page 3

Volunteer Awards Presented for '98

Three outstanding volunteers were singled out for recognition at West Midland Family Center's annual Appreciation banquet.

The Orrin Barrett Volunteer of the Year Award was presented to Jim Burlingame. Elaine Fabinski was the 1998 winner of the Phyllis Breedlove Friend of the Center Award, while Fred Rebhun was named the Steven Barstow Youth Volunteer of the Year.

Jeff Phillips, Professor at Northwood University and an accomplished cartoonist, gave an inspirational and motivational presentation in praise of volunteerism. Entertainment was provided by Praise Partners, whose home-spun humor, involving the audience, had just the right touch. Co-chairs Sue Thumma and Tom Misner and their Committee were responsible for a superb meal and the spectacular 25th Anniversary decor.

In presenting the award to Burlingame, West Midland Family Center's New Initiatives and Promotions Director Alan Oman related his contributions to the Center over a 10-year period. Jim served six years on the Board of Directors where he was an active member of the Executive, Activities and Communications committees. He was also Secretary of the Board. Although retired from the Board, he continues to serve as a member of the

See VOLUNTEERS RECOGNIZED, Page 2



WMFC Adds New Preschool Class



Sara Batch and new pupil.

As part of the expansion process at West Midland Family Center, a third preschool class is planned for September 1999. The new class will allow for an additional 18 four-year-olds to attend preschool at the Center in the fall bringing total preschool enrollment to 54.

In order to serve these new children Sarah Batch has been hired as the Center's second preschool teacher. Sarah is a Midland County native who graduated from Central Michigan University with a Bachelor of Applied Arts in Child Development.

Until recently, Sarah worked in Lansing as an Early Childhood Education Coordinator, supervising three preschool classes. Sarah states, "it's great to be back home in Midland County."

In addition to planning preschool activities for the fall, Sarah will be helping with the Center's summer program activities for children in Kindergarten and Grade 1. Program Director Gail Crosby says: "we were so pleased to be able find Sarah. Her enthusiasm and drive will fit right in with the preschool team we have at the Center."

If you have a child who will be four by December 1, contact the Center about our state funded preschool program. Classes are available regardless of income level. Although a third class is planned for the fall, the program is already filling up so parents need to act quickly to secure a spot for their child.

Volunteers Recognized at Awards Banquet

(continued from page 1)

Communications, Building Expansion and 25th Anniversary committees.

"Mr. Communications" designed our logo, authored our Mission Statement and has produced the majority of our printed materials. He started and continues to edit FAMILY FOCUS.

Following service as a Naval aviator in World II, Jim received his degree in Journalism from Michigan State. During his more than 50 years in the broad field of communications, he has served as a Board member in several trade associations, and has been recognized with many awards for professional achievement.

His dedication and contribution of time and talent continue to be invaluable to West Midland Family Center.

Elaine Fabinski was honored as the 1998 recipient of the Phyllis Breedlove Friend of the Center Award. Elaine has been a valuable member of the staff for more than 10 years. During that time, she has served the Center as teacher, mentor, guide and friend. The fact that the Center's current Programs Director, Childcare Director, and Family Support Coordinator all began their careers as part-time aides in her program is strong testimony to her inspiring dedication.

She is, in large part, responsible for the transition of the Center's preschool into today's Michigan School Readiness Program... and the program is recognized as one of the best in the state. Elaine holds a BA in Elementary Education and a Masters in Early Childhood Education from Michigan State. She received her ZA endorsement as an Early Childhood Specialist from Saginaw Valley in 1990.

Elaine's conviction and passionate commitment have been, and continue to be an inspiration to her classes and all her friends at West Midland Family Center.

This year's honoree as the Steven Barstow Youth Volunteer of the year is Fred Rebhun, a "veteran" who in four years in the T'N'T Program has volunteered more than 1,200 hours.

According to Wyndy Johnson, Coordinator of Youth and Teen Activities, "Fred shares his talents and never-ending energy with great enthusiasm." Much of his time at West Midland Family Center, where he started attending as a child, has

been spent working with the children in the Center's after-school program and in the "Sun" sational Summer Program. He often gives up his Saturday evenings to make things happen at the Center.

Fred has never expected anything in return for his volunteer time...and always gives more than is expected. His constant smile and contagious laughter are testimony to how rewarding he finds his efforts on behalf of others.

Outside of the Center, Fred is a sophomore at Shepherd High School, where he is a member of the JV football team. He plays hockey or soccer every chance he gets in the "off-season". Fred plans to join the armed forces following graduation to assure achieving a college education.

WEST MIDLAND FAMILY CENTER

OFFICERS AND DIRECTORS

President.....Bob Dostal
Vice PresidentJim Anderson
SecretarySue Thumma
Treasurer.....Joe VanderKelen

Directors: Julie Arbury, Stephen Carras, Ben Dollard, Chuck Infante, Don Koster, Amber Phillips, Jo Ann Winchester

Advisors: Jim Burlingame, Michael Custer, Gene Dauer, Tom Misner, Chuck Norisez, Joe Rodgers, Roland Weaver, Ralph Wirtz, Win Zacharias

STAFF

Executive DirectorGreg Dorrien
Program Director.....Gail Crosby
New Initiatives & Promotions Director...Alan Oma
Office ManagerRebecca Lampman
Office Supervisor.....Diane DeMott
Receptionists: Teri Booth, Diane Dauer, Mary Helton, Jenny Yarch

Maintenance DirectorBarry Lenski
Maintenance Staff: Gerald Burkett, Mike Kirby, Karen Leath

Dow College Opportunity Director.....Tracy Meister
Youth & Teen Coordinator.....Wyndy Johnson
Youth & Family Education Coordinator..Renee Shauger
Youth & Teen Staff: Alex Bartlett, Anita Bass, Tom Berlin, Jessica Booth, Carmen Briggs, Jill Chartier, Trish Finerly, Nicki Gainsforth, Stacie Gath, Paul Haske, Laura Hitchuk, Jeff Jaster, Chad Johnson, Betty Jones, Kyle Kipp, Annette Kreger, Joel LaMee, Jim Leach, Julie McKeith, Wendy McLean, Jason Parks, Chris Pieper, Andrea Strohm, Heidi Varner, Danielle Willsie, Stephanie Wirtz

Family Support Coordinator.....Lois Burton
Family Resource CoordinatorJessica Pieper
Preschool Teachers:.....Sarah Batch, Elaine Fabinski
Preschool Teacher Assistant.....Barb Simons
Preschool Aides:.....Missy Finney, Karen Hall
Preschool Van Driver.....Bryan Fowler
Preschool Van AideCari Kline
NEMCSA Head Start TeacherKathy Brown
NEMCSA Head Start AideKim Hackett
Child Care DirectorGinger Yarch
Child Care Aides: Sarah Amick, Eileen Burc

Connie Billings, Shannon Cottrell, Anabelle Curtis, Stephanie DeLong, Sherry Huskins, Penny Owen, Nicole Schlese, Eva Searfoss, Becky Sexton

Senior Staff.....Susan Wells
Council On Aging Site Manager.....Judy Wirtz
AmeriCorps MemberKari Maples
Interns:..... Amy Clare, Eric Konopka, Kathy Snyder

1999 WMFC BENEFACTORS

Organization

Amount

Herbert H. and Grace A. Dow Foundation.....	\$1,500,000*
Herbert H. and Grace A. Dow Foundation.....	1,000,000**
State of Michigan	124,236
United Way of Midland County	72,187
Towsley Foundation	45,000
Vada B. Dow Charitable Trust	41,000
WMFC Auxiliary.....	13,500
Midland Foundation	12,646
United Way Venture Grants	7,250
Children's Trust Fund	5,972
Snow Machines Inc.	3,100
Bergstein Foundation.....	2,200
Midland Kiwanis Club	1,000
Dow High School Student Body	984
Sunrise Optimist Club	607
Blessed Sacrament Church.....	600
Childcare Concepts.....	435
Bailey Insurance Agency.....	100
Homer United Methodist Church.....	100
TOPS Michigan	100
Gordonville United Methodist Church.....	50

Individual Benefactors:

Susan Antoine, Ben & Kathy Dollard, Alan & Julie Oman, Scott and Janice Sovereign, Win Zacharias

*Pledged over a 3 year period towards the Center's expansion project.

**5 year matching grant pledge towards the Center's Program Endowment Fund.

Floor Plan Shows Additions Related to Current Facility

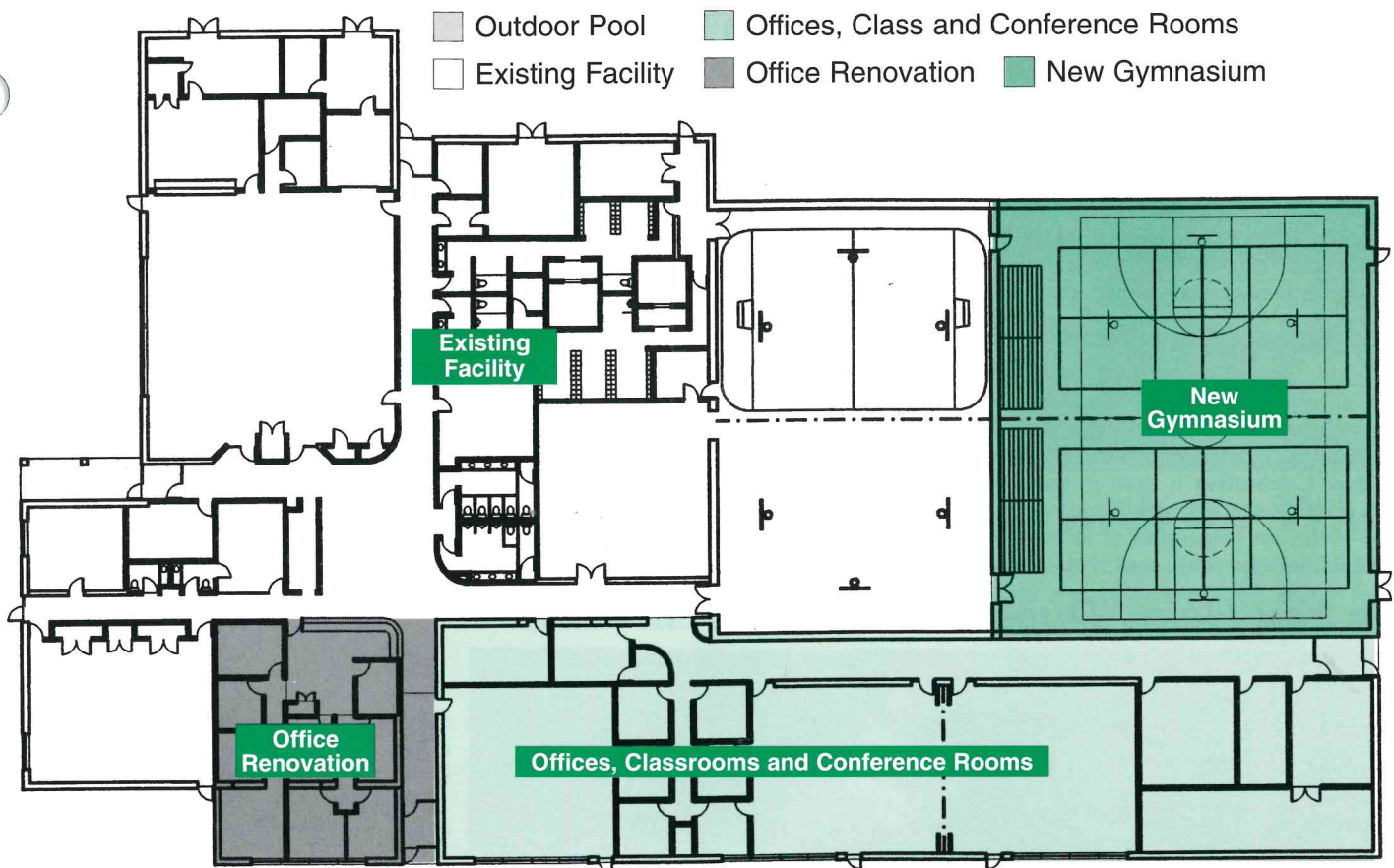

Expansion Project...

(continued from page 1)

find it increasingly difficult to serve the community as we should. We are at the point where we cannot add programs and services, which would be of real benefit. We are literally bursting at the seams."

Dostal said: "The estimated total cost of the expansion project is \$2.8 million. Initial expenditures are planned for mid-1999, with ground breaking set to occur in early 2000 and completion in late 2000."

Dostal continued: "We are most pleased to announce that The Herbert H. and Grace A. Dow Foundation has expressed its approval of this ambitious project with a contribution of \$1.5 million. We hope to secure additional support from local foundations and industry, both of which were so generous with their contributions toward the building of our current facility."

H. D. "Ted" Doan, President of the Dow Foundation, said: "These people at West Midland Family Center have proven that they know how to effectively and efficiently utilize the funds they receive. We are most impressed with the work of the Board and the Expansion committee in pre-planning. The Dow Foundation is pleased to be able to help make a 'new' dream come true."

Several groups at the Center are involved in fund raising. Center youth have contributed the profits from their Spring "Egg"stravaganza, while the Bingo Auxiliary volunteers have hosted a special Marathon Bingo. The kids are also putting their nickels and dimes in a "Parking Meter" stationed at the front desk. "Many adults have made anonymous contributions that are greatly appreciated," said Dorrien. "The outpouring of support, and the kindness received from all segments of society, are major benefits our staff enjoy in working at West Midland Family Center," according to Dorrien.

He added further, "the people who use the Center—from toddlers to seniors—our hundreds of volunteers, and our entire staff are dedicated to the project. With the help of our many benefactors, we feel confident we can make it happen."

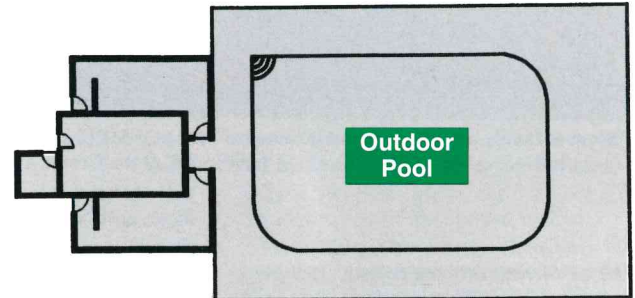

Dow Matching Grant...

(continued from page 1)

become possible with the expansion of the center (see related story).

According to Bob Dostal, Center President, "we don't plan to conduct an aggressive campaign. We hope this very generous 3 for 1 match will provide an incentive for our current supporters... and also encourage some new donors to participate."

Donations, large and small, will add up fast...because they multiply so rapidly with this type of grant. If a person donates \$100.00, that automatically secures \$300.00 from the matching grant. In many instances, employers will match any employee's contribution. That would turn \$100.00 into \$200.00...and the match of \$600.00 would turn the \$100.00 donation into a total of \$800.00.

Those interested in contributing, or making a pledge, should contact Greg Dorrien at 832-3256 or Toll free at (877) 631-9632.

NEW PRESCHOOL CLASS

West Midland Family Center is starting an additional Preschool Class so we can accommodate families in need of this special service. Children must be 4 years old by December 1st. Call Gail at 832-3256 for details.

Silver Celebration Highlight of Summer Anniversary Festivities

Regular visitors to the Center and readers of this newsletter will know that this year marks the 25th Anniversary of the Center's founding. Throughout the year, a number of special events have been planned to celebrate the anniversary and to mark the contributions made by various members of our community.

In April we celebrated with the Center's many volunteers at a dinner that recognized the efforts they have made over the last 25 years. Other separate events are planned to mark the contributions made by the Center's many benefactors, and employees and their spouses.

Thursday, August 5, from 5:00-8:00 pm, will provide an opportunity for the community as a whole to come together to celebrate our 25th year of service to the west Midland community. The **Silver Celebration** is open to the entire general public as well as regular Center patrons. Special events for participants of all ages are planned, including a baby crawl, a dunk tank,



moonwalk, hula-hoop contest, hokey pokey dance, family photographs, and drawings for prizes. The Celebration will include a delicious full-course meal including roasted pig, hot dogs, and a variety of salads, as well as a host of events for participants from infants to seniors.

Can You Help "Duplicate" This "New" Car?



The Spencer family recently received a "donated" car at WMFC. There have since been three more. Who will make it five... or six... to help working families? Call the Center at 832-3256.

The highlight of the evening's activities will be the presentation of special souvenirs that have been designed to mark the occasion for every child who attends the event.

The Silver Celebration is sure to be the highlight event of the summer, so be sure to mark the date in your calendars now!

Ginger Yarch Wins Strosacker Award...

(continued from page 1)

Gail Crosby, WMFC's Program Director, says of Yarch; "What motivates Ginger is she really wants to help people." Executive Director Greg Dorrien adds; "When I look back at previous winners of the Strosacker Award, I see people who have had a vision. They've been willing to get with other people to help that vision come about, then they've been willing to work like dogs to make sure it's successful. And Ginger definitely belongs in that group."

In the nine years since the award was introduced, it has been presented to a staff person from West Midland Family Center four times. Former Executive Director Phyllis Breedlove was the recipient in 1991, Gail Crosby in 1994 and Lois Burton in 1996. Ginger became the fourth winner in 1998.

In the video that accompanied the presentation ceremony, child care parent Luann Fellows stated: "Ginger, I want you to know the positive impact you've had on my life and my children's lives. I really appreciate the care that you've shown me and my children throughout the past two years. I think you're a wonderful person and I think you're genuine, ...and I really appreciate you being there for me and my children. Thank you."